

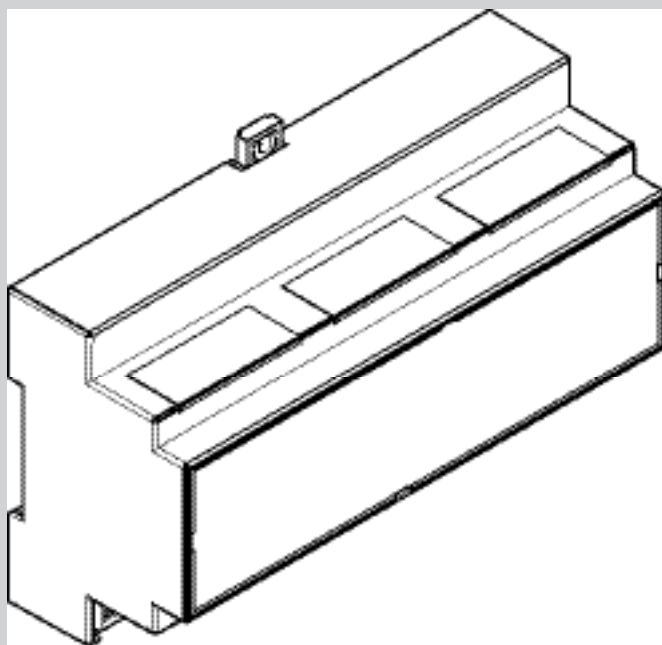

CLIQ® Local Manager Remote



CLM Remote Controller

Installation instructions

PB00139 00027 000 0A

medeco[®]
ASSA ABLOY

Read this manual thoroughly before use and keep it in a safe place for later reference. The manual contains important information about the product, particularly for its intended use, safety, installation, use, maintenance and disposal.

Hand the manual over to the user after installation and pass the manual on to the purchaser together with the product if the product is sold.

Open Source Licenses ASSA ABLOY *Sicherheitstechnik GmbH* has the source code of the software used in the scope of Open Source licenses (such as Raspbian) available on request:
<http://www.assaabloy.com/com/global/opensourcelicense/>

Publisher

Medeco
 3625 Alleghany Dr.
 Salem, Virginia 24153

Phone: 1.877.633.3261
 Email: customersupport@assaabloy.com
 Website: www.medeco.com

Document number and date

PB00139 00027 000 0A 09.2022

Copyright

© 2022, ASSA ABLOY

This document and all its parts are copyrighted. Any use or changes outside the strict limits of the copyright are prohibited and liable to prosecution unless prior consent has been obtained from Medeco.

This particularly applies to any copying, translations, microforms, or storing and processing in electronic systems.

Table of contents

Notices	4
About this manual	4
Meaning of the symbols	4
Safety instructions	5
Intended use	6
Operation	7
General Description	7
Installation	8
Installing the CLM Remote Controller	9
Power supply	9
Connections	10
Commissioning/decommissioning	11
Technical data	12
Certification	12
Warranty, disposal	14
Warranty	14
Updated information	14
Disposal	14

Instructions

About this manual

This manual was written for electricians and appropriately trained personnel. The manual was designed to enable you to install and operate the device safely and make full use of the permitted range of applications the control terminal has to offer.

Meaning of the symbols



Danger!

Safety notice: Failure to observe these warnings will lead to death or serious injury.



Warning!

Safety notice: Failure to observe these warnings may lead to death or serious injury.



Caution!

Safety notice: Failure to observe these warnings may lead to injury.



Important!

Note: Failure to observe these warnings can cause damage and impair the product's function.



Note!

Note: Additional information on operating the product.

Safety instructions



Warning!

Danger arising from modification of the product: The safety features of this product are an essential requirement for its conformity with EltVTR. Changes other than those described in this manual may not be made.

Danger due to faulty commissioning: In order to ensure the safety of the product, commissioning must be performed by a qualified person. *Medeco* offers training for qualification in the requisite skills. Any work on electrical connections may only be carried out on the *CLM Remote Controller* and control devices when they are in a de-energised state to eliminate any risk of physical injury or damage to the equipment. Observe VDE regulations in this respect.

Danger due to faulty maintenance: The owner is responsible for properly installing and checking the functioning of the product and connected components. The safe function must be tested by a trained qualified expert at least once per year. Requirements established by inspection authorities must be complied with. *Medeco* offers training for qualification in the requisite skills.



Caution!

Risk of injury due to damage: The device must not be used if it is damaged. Damaged cables and connector assemblies also represent a safety hazard and must not be used.

Intended use

The *CLM Remote Controller* (Fig. 1) is used to control *CLIQ* wall-mounted programmers in the same local network. The data transfer between *CLIQ Local Manager* and *CLM Remote Controller* takes place via Ethernet.

The *CLM Remote Controller* is prepared for installation on DIN rails in accordance with DIN EN 60715 TH35 and can be installed there. BUS cabling is carried out via the Ethernet connection (LAN cable).

The *CLM Remote Controller* is suitable for installation and use in accordance with these instructions. It is not intended for any other type of use.

Fig. 1:
CLM Remote Controller

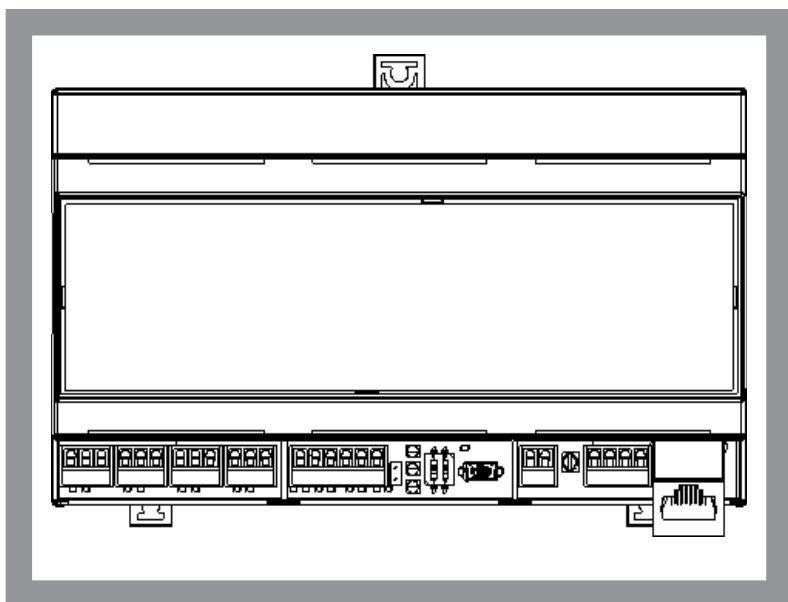

Operation

General description

The controller is used to control wall-mounted programmers in conjunction with the *CLM* with remote extension, via an Ethernet interface for integration into a local network (LAN)

max. 3 active wall-mounted programmers

The *CLM Remote* solution is limited to up to three wall-mounted programmers, with both regular and vandal-proof wall-mounted programmers (.R01 and .R03) supported.



Note!

The functionality of the wall-mounted programmers is ensured via the *CLM Remote Controller*, even when the PC is switched off. LAN must be active between the *CLM Remote Controller* and the wall-mounted programmer.

Installation



Warning!

Danger due to faulty installation: The controller module and the wall-mounted programmers connected to the local network may only be installed and set up for operation by a qualified electrician.

Danger due to non-compliance with the applicable regulations: You must observe and comply with the German Electrical Engineering Association (VDE) and local electricity company regulations when installing equipment. You must also comply with safety regulations regarding work on electrical systems.



Important!

Components at risk of electrostatic discharge: Electronic components in equipment should not be touched to ensure that electrostatic discharge does not cause injury or damage. If you cannot avoid touching electronic components, you should use a suitable anti-static tool.

To ensure that the risk of electrostatic discharge is kept to a minimum, the person who is working on the system should ensure that they are not carrying an electric charge. They should take suitable measures such as wearing an anti-static wrist strap.

Installing the CLM Remote Controller

The *CLM Remote Controller* is intended for installation in a suitable electrical distributor.

It can be mounted on top-hat rails in accordance with DIN EN 60715 TH35.

Installation
location

The installation location of the *CLM Remote Controllers* must meet the following conditions:

- It must be on the inside of the building.
- It must not be exposed to any unusual environmental conditions, such as aggressive vapours or high humidity.
- The CLM Remote Controller should be easily accessible in a secured and protected area and not be exposed to direct sunlight.
- When mounting the CLM Remote Controller on the wall, take care not to damage any wiring or pipes inside the wall itself. The module rack for the CLM Remote Controller and fastening screws must not come into contact with conductive elements in the building's structure.

Power supply

external power
supply

The *CLM Remote Controller* must be powered by an external power supply.

The power supply must meet the appropriate specifications ("Technical data", page 12).

Battery

In the event of a power failure, the battery buffers the RTC (real-time clock).

The battery only needs to be removed when the device is taken out of operation and sent for disposal ("Disposal", page 14).

Connections

Fig. 2:
Terminal strip

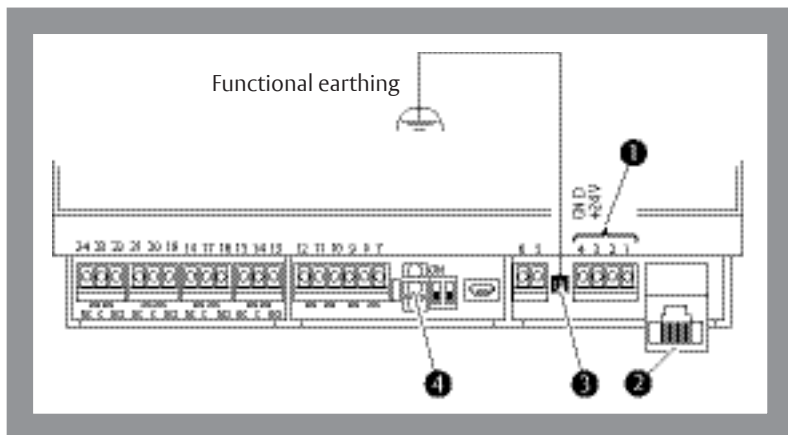

Tab. 1:
Key for Fig. 2

Pos.	No.	Description	Pos.	No.	Description
①	1	reserved	③		Functional earthing FE
	2	reserved			
	3	supply + 24V			
	4	supply 0V			
②		Ethernet	④		LEDs for status display: illuminated LEDs signal power supply

Commissioning/decommissioning

Commissioning the CLM Remote Controller

- 1 Connect the power supply of the *CLM Remote Controller* via the power supply unit.
⇒ After switching on, the operating status is signalled via the LEDs.
- 2 Switch on your PC and make the required settings in the *CLIQ Local Manager*.
Follow the instructions in the *CLIQ Local Manager* manual (PB00118)

Decommissioning – Remove battery before disposal



Important!

Material damage may result from removing the battery: It is not necessary to remove the battery during normal use of the device. Opening the housing can damage the device.

- Only open the housing before disposing of the battery

- 1 Disconnect all clamps.
- 2 Follow the instructions shown (Fig. 3).

Fig. 3:
Remove battery

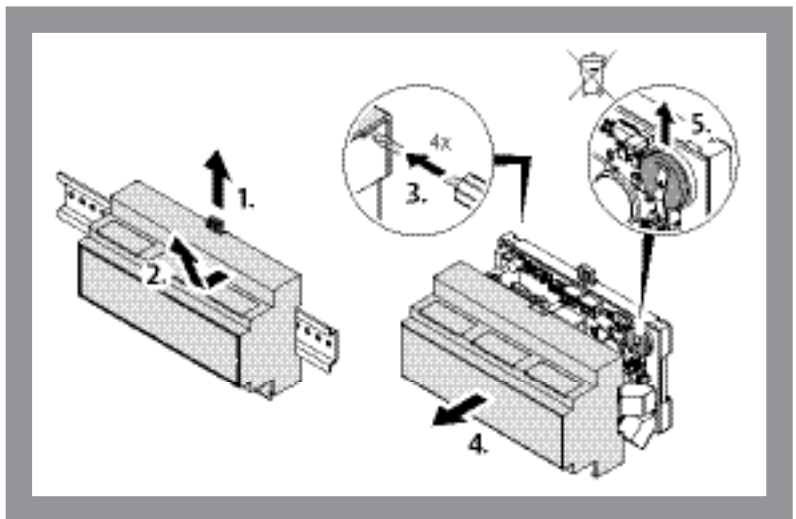

Technical data

Feature	Characteristic
Input voltage range	24VDC(+10%) SELV
Maximum current consumption:	400 mA
Application site	for use in indoor areas
Protection rating	IP 30 (when completely mounted)
Operating temperature	0°C to +40°C
Battery real time clock (RTC)	CR2032 Lithium coin cell, 3V 210mAh
Battery life	approx. 5 years – varies depending on the quality of the coin cell used
Ethernet interface	RJ45 Transmission rate 100 MBit/s IEEE standard 802.3-100BASE-TX
Casing	Distributor installation top-hat rail in accordance with DIN EN 60715 TH35

Certification



ASSA ABLOY Ltd.

School Street
West Midlands
WV13 3PW
UNITED KINGDOM

www.assaabloy.com/de

The EU declaration of conformity is available in the download area of www.assaabloy.com/de

Warranty, disposal

Warranty

The statutory warranty periods and *Medeco's Terms and Conditions of Sale and Delivery* (www.assaabloy.com/de) apply.

Latest information

The latest information is available at: www.assaabloy.com/de

Disposal

The following applies to products marked with the symbol  (crossed out dustbin):

The applicable environmental protection regulations must be observed. Do not dispose of lamps, disposable and rechargeable batteries, electrical devices or personal data in the household waste.

Lamps and used disposable and rechargeable batteries must be removed from the device without damaging them and then disposed of separately.

Packaging

Packaging materials must be recycled. You can also give packaging material to the distributor or trade professional for disposal free of charge at the place of handover.

Batteries

Button cell
CR 2032

The product contains disposable or rechargeable batteries. Batteries and accumulators must be removed from the product ("Decommissioning – Remove battery before disposal", page 11) and disposed of separately.

Used batteries should not go in household waste and can be returned to any local collection point free of charge. You are legally obliged to recycle used batteries.

N **Product**

WEEE reg. no. DE 69404980

You must dispose of the product correctly as electronic scrap after use and take it to a local collection point for recycling free of charge.

You have the following additional options for free disposal through the distributor:

- Return an old device with similar functions at the place where the new device is delivered.
- Return a maximum of three similar old appliances (max. edge lengths 25 cm) to a retail store with no obligation to purchase a new one.

The take-back obligation applies to distributors of electrical appliances with a sales area of over 400 m² or to distributors of foodstuffs that offer electrical appliances several times a calendar year or continuously with a total sales area of 800 m². In the case of online providers, the total storage and shipping areas for electrical appliances are considered to be sales areas. For further details, see ElektroG3 §17 (1)(2).

Distributors using means of remote communication must, upon delivery, collect or take away free of charge heat exchangers, screens, monitors and devices containing screens with a surface area greater than 100 square centimetres and devices in which at least one of the external dimensions is greater than 50 centimetres. For lamps and smaller devices in particular, they must ensure suitable return options at a reasonable distance.