

PaxLock Pro - Deadbolt Mortise Lock

Features

Mechanism	Stainless steel
Backset	2-3/4"
Deadbolt	1"
Latchbolt	3/4"
Door Thickness	1-3/4"
Fronts	Bevel front, free-floating to adjust from flat to standard bevel of 1/8" in 2"
Strikes	1-1/4" curved lip for 1-3/4" door standard; all reversible

Certifications

ANSI/BHMA: Certified ANSI/BHMA A156.13, Series 1000, Operational Grade 1	✓
UL-cUL: UL/cUL fire rated up to 3 hours	✓
Windstorm: Certified (refer to local codes)	✓

Dimensions

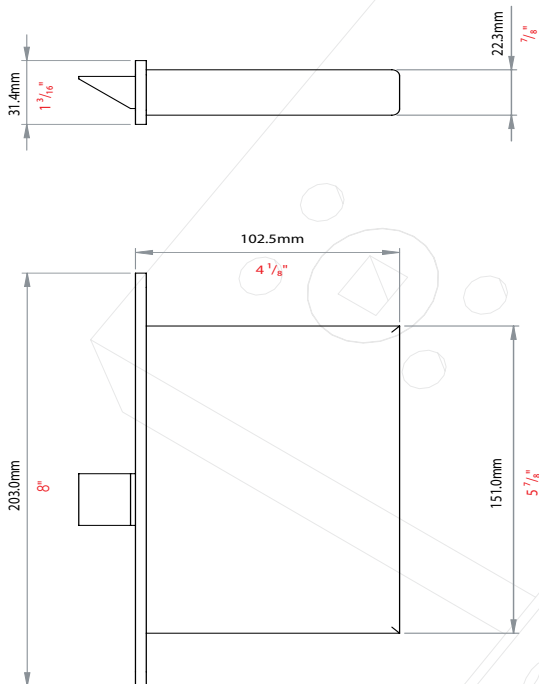

The PaxLock Pro - Deadbolt Mortise lock is a Yale 8800 series lock case, modified to work with the PaxLock Pro - Mortise. This lock case contains a deadbolt.

Sales codes

PaxLock Pro - Mortise, Galaxy, white	900-140-WT-US
PaxLock Pro - Mortise, Galaxy, black	900-140-BL-US
PaxLock Pro - Mortise, Eclipse, white	900-150-WT-US
PaxLock Pro - Mortise, Eclipse, black	900-150-BL-US
Paxton10 PaxLock Pro - Mortise, Galaxy, white	900-640-WT-US
Paxton10 PaxLock Pro - Mortise, Galaxy, black	900-640-BL-US
Paxton10 PaxLock Pro - Mortise, Eclipse, white	900-650-WT-US
Paxton10 PaxLock Pro - Mortise, Eclipse, black	900-650-BL-US

Locks

PaxLock Pro – Latchbolt Mortise lock	901-053-US
PaxLock Pro – Deadbolt Mortise lock	901-054-US
PaxLock Pro – 1½" Mortise lock cylinder	901-058-US

Accessories

PaxLock Pro - Mortise, 2" door kit	900-061-US
PaxLock Pro - Mortise, 2-1/4" door kit	900-062-US

Demo Kit

PaxLock Pro - US Demonstration kit, Mortise & Latch	900-901-US
---	------------



PaxLock Pro - Latchbolt Mortise Lock

Features

Mechanism	Stainless steel
Backset	2-3/4"
Latchbolt	3/4"
Door Thickness	1-3/4"
Fronts	Bevel front free-floating to adjust from flat standard bevel of 1/8" in 2"
Strikes	1-1/4" curved lip for 1-3/4" door standard; all reversible

Certifications

ANSI/BHMA: Certified ANSI/BHMA A156.13, Series 1000, Operational Grade 1

UL-cUL: UL/cUL fire rated up to 3 hours

Windstorm: Certified (refer to local codes)



Dimensions

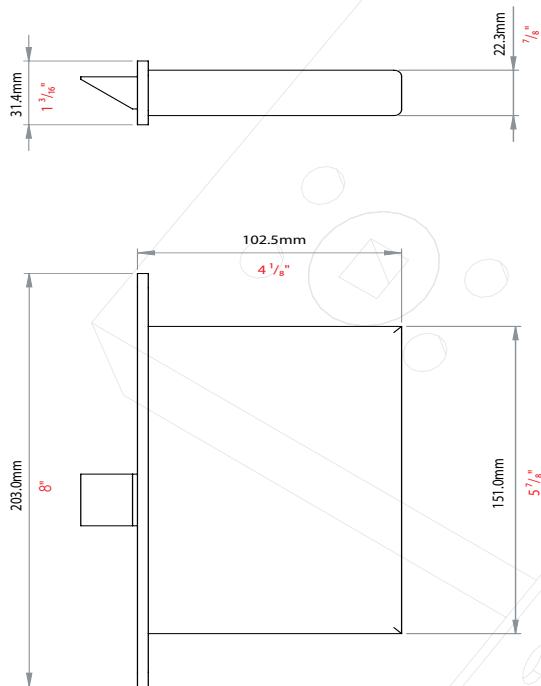

The PaxLock Pro - Latchbolt Mortise lock is a Yale 8800 series lock case, modified to work with the PaxLock Pro - Mortise.

Sales codes

PaxLock Pro - Mortise, Galaxy, white	900-140-WT-US
PaxLock Pro - Mortise, Galaxy, black	900-140-BL-US
PaxLock Pro - Mortise, Eclipse, white	900-150-WT-US
PaxLock Pro - Mortise, Eclipse, black	900-150-BL-US
Paxton10 PaxLock Pro - Mortise, Galaxy, white	900-640-WT-US
Paxton10 PaxLock Pro - Mortise, Galaxy, black	900-640-BL-US
Paxton10 PaxLock Pro - Mortise, Eclipse, white	900-650-WT-US
Paxton10 PaxLock Pro - Mortise, Eclipse, black	900-650-BL-US

Locks

PaxLock Pro – Latchbolt Mortise lock	901-053-US
PaxLock Pro – Deadbolt Mortise lock	901-054-US
PaxLock Pro – 1½" Mortise lock cylinder	901-058-US

Accessories

PaxLock Pro - Mortise, 2" door kit	900-061-US
PaxLock Pro - Mortise, 2-1/4" door kit	900-062-US

Demo Kit

PaxLock Pro - US Demonstration kit, Mortise & Latch	900-901-US
---	------------



PaxLock Pro - Latch

System specifications

Maximum total tokens	100 card packs (up to 5,000 tokens/users)
Maximum total users	10,000
Token compatibility	Paxton EM MIFARE ® (UID only)
Cloning resistance	Low
Stored events	16,000
Hands free compatible	No
Door open time	1 - 60 seconds
Silent operation	Yes
Door traffic	Typically up to 75 uses per day

Electrical

Battery type	4x AA 1.5V Alkaline
Battery life	55,000 Operations

Communication

Wireless	Bluetooth** 2.4GHz (IEEE 802.15.4)
Default channel	25
Recommended wireless devices per Net2Air Bridge	10
Typical wireless range	Bluetooth** 15m/50ft
Encryption	AES128

Features

Door widths supported	1-3/4" 2" (door kit required) 2-1/4" (door kit required)
Door contact	N/A
Rear handle exit request	Yes
Low battery warning	Yes
Depleted battery jumpstart terminals	Yes
Color	Black or White

Lock case compatibility

Backset	2- 3/8" 2- 3/4"
Rotation	≤45°
Cylinder type	N/A
Single action egress	Yes
Compatibility	PaxLock Pro - Tubular latch 2- 3/8" 901-051-US PaxLock Pro - Tubular latch 2- 3/4" 901-052-US

Environment

Operating temperature	Reader side: +32°F ~ +120°F Battery side: +32°F ~ +120°F
Fire resistance	N/A



The PaxLock Pro - Latch represents Paxton's 3rd generation of electronic door handle; offering a robust, featureful and aesthetically pleasing product suitable for a multitude of installations.

The new design has been created to be both simple to install, intuitive to use and backed up by Paxton's market leading 5 year warranty.

Offering three modes of operation the user can choose to use the PaxLock Pro - Latch as a standalone offline device, connect it to a Net2 system via a Paxton Net2Air bridge or connect it to a Paxton10 system via a Paxton10 Wireless Connector.

- Dual frequency reader
- Wireless real-time event reporting
- When PaxLock Pro - Latch is unlocked the handle moves freely
- Compatible with standard cylindrical doors using tubular latch
- Dual standalone and online functionality in one unit

FCC part 15	✓
ISED	✓
UL294	✓

Dimensions

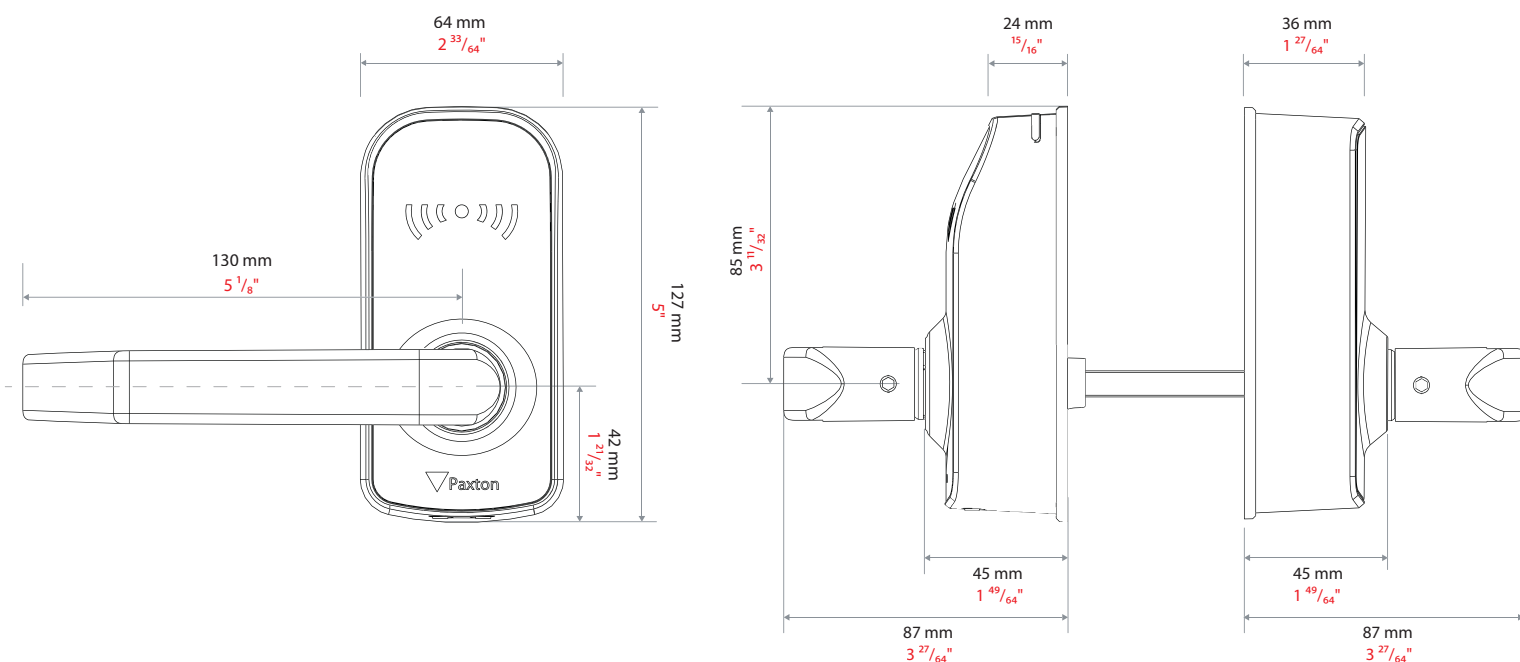

Sales codes

PaxLock Pro - Latch, Galaxy, white
 PaxLock Pro - Latch, Galaxy, black
 PaxLock Pro - Latch, Eclipse, white
 PaxLock Pro - Latch, Eclipse, black

900-625WT-US
 900-625BL-US
 900-635WT-US
 900-635BL-US

Accessories

PaxLock Pro - Latch, 2" door kit
 PaxLock Pro - Latch, 2-1/4" door kit

900-059-US
 900-060-US

Demo Kit

PaxLock Pro - US Demonstration kit, Mortise & Latch

900-695-US

* Only compatible when part of a Paxton10 system

PaxLock Pro - Mortise

System specifications

Maximum total tokens	100 card packs (up to 5,000 tokens/users)
Maximum total users	10,000
Token compatibility	Paxton, EM4100/02, MIFARE®, MIFARE® Classic, MIFARE® DESFire® EV1, MIFARE Plus®, MIFARE Ultralight®, MIFARE Ultralight C®, MIFARE Mini®, HID® Prox, Sony®, FeliCa Lite-S®, NFC
Stored events	16,000
Hands free compatible	No
Door open time	1- 60 Seconds
Silent operation	Yes
Door Traffic	Typically up to 75 uses per day

Electrical

Battery type	4x AA 1.5V Alkaline
Battery life	55,000 Operations

Communication

Wireless	Bluetooth** 2.4GHz (IEEE 802.15.4)
Default Channel	25
Recommended wireless devices per Net2Air Bridge	10
Typical wireless range	Bluetooth** 15m/50ft
Encryption	AES128

Features

Door widths supported	1-3/4" 2" (door kit required) 2-1/4" (door kit required)
Door contact	N/A
Rear handle exit request	Yes
Low battery warning	Yes
Depleted battery jumpstart terminals	Yes
Colour	Black or White

Lock case compatibility

Backset	2-3/4"
Rotation	≤45°
Cylinder type	N/A
Single Action Egress	Yes
Mortise Suitability	Yale® Latchbolt Mortise Lock 901-053-US Yale® Deadbolt Mortise Lock 901-054-US

Environment

Operating temperature	Reader side: -31°F ~ +151°F Battery side: +32°F ~ +120°F
Moisture resistance	UL294 exterior rated (reader side only)
Fire resistance	UL10C 3hrs



The PaxLock Pro - Mortise represents Paxton's 3rd generation of electronic door handle; offering a robust, featureful and aesthetically pleasing product suitable for a multitude of installations.

The new design has been created to be both simple to install, intuitive to use and backed up by Paxton's market leading 5 year warranty.

Offering three modes of operation the user can choose to use the PaxLock Pro - Mortise as a standalone offline device, connect it to a Net2 system via a Paxton Net2Air bridge or connect it to a Paxton10 system via a Paxton10 Wireless Connector.

- Dual frequency reader
- Wireless real-time event reporting
- When PaxLock Pro - Mortise is unlocked the handle moves freely
- Dual standalone and online functionality in one unit

FCC Part 15	✓
ISED	✓
UL 294	✓
Tested to ANSI 156.25	✓
UL10C/ ULC S104	✓

Dimensions

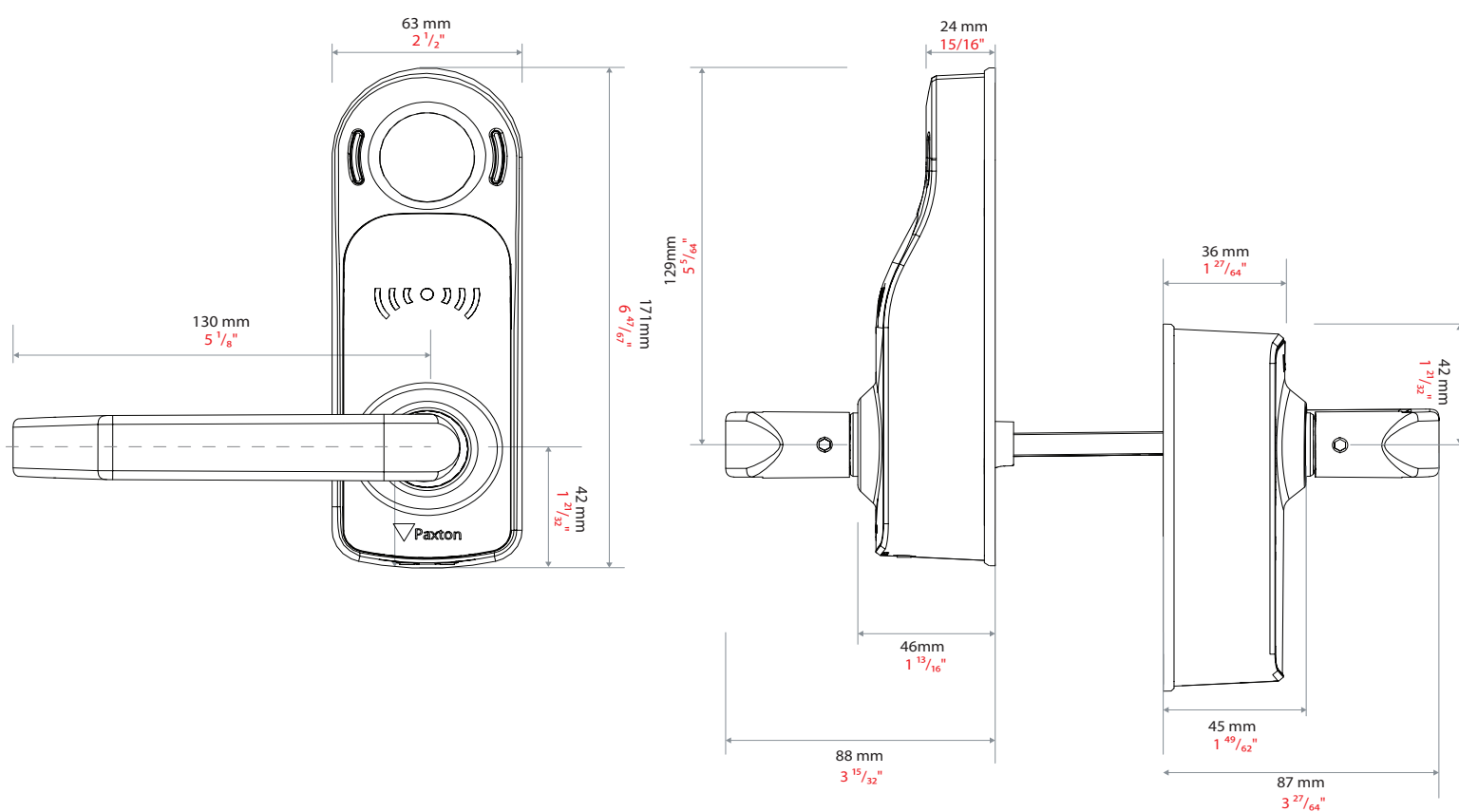

Sales codes

PaxLock Pro - Mortise, Galaxy - white	900-640WT-US
PaxLock Pro - Mortise, Galaxy - black	900-640BL-US
PaxLock Pro - Mortise, Eclipse - white	900-650WT-US
PaxLock Pro - Mortise, Eclipse - black	900-650BL-US

Locks

PaxLock Pro - Latchbolt Mortise Lock	901-053-US
PaxLock Pro - Deadbolt Mortise Lock	901-054-US
Yale® 1 1/2" lock cylinder	901-058-US

PaxLock Pro - Mortise, 2" door kit

900-061-US

PaxLock Pro - Mortise, 2-1/4" door kit

900-062-US

Demo Kit

PaxLock Pro - US Demonstration kit, Mortise & Latch

900-695-US



* Only compatible when part of a Paxton10 system

Net2Air Bridge

System specification

PoE compliant	IEEE 802.3 af/at
Cable type	CAT5
Weight	226 grams

Electrical

Operating Voltage	IEEE 802.3af (15.4W)
Wireless frequency	2.4GHz (802.15.4)
DHCP support (fixed IP recommended)	Yes

Hardware

Plasterboard fixing Tensile resistance	0.06kN
Plasterboard fixing Shear resistance	0.18kN

Communication

TCP/IP	Yes (Maximum 200 including other ethernet devices - Net2 Plus, I/O Boards)
LED status indication	Yes
Typical wireless range	15m/50ft
Encryption	AES128 bit

Environment

Operating Temperature	-0° - +50° +4F° - +131F°
Moisture resistance	No
Vandal resistance	No

Certification

UL	60950-1
----	---------



The Net2Air bridge uses Paxton Access' Net2Air wireless technology to communicate with the Net2 software. The Net2Air Ethernet bridge provides the wireless communication link between the PC running Net2 and wireless control units such as the Paxlock Pro or Net2 Nano.

The Ethernet bridge uses a site's LAN which means that multiple Ethernet bridges can be placed around a site and linked back to the PC.

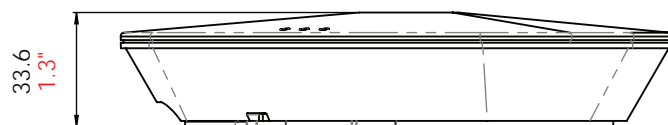
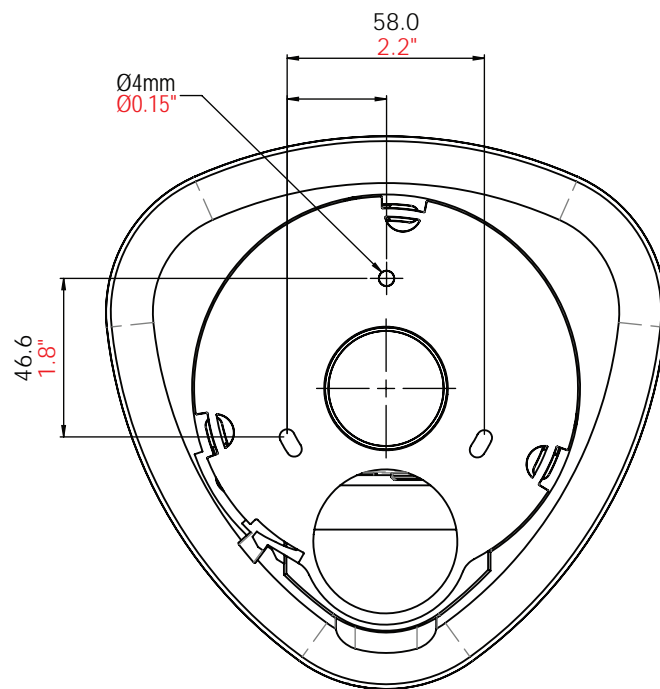
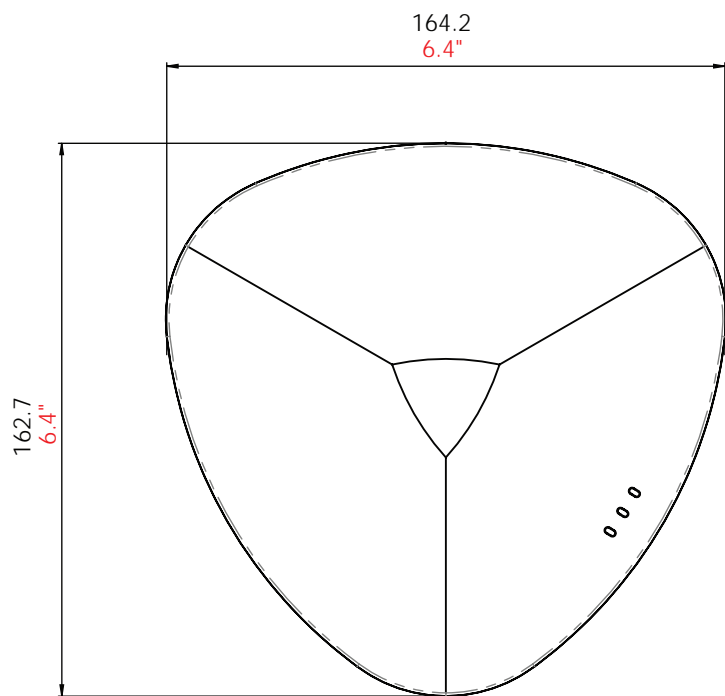

Accessories and sales codes

Net2Air bridge

477-600-US

Net2 PaxLock

System specifications

Maximum total users/tokens	50,000
Token compatibility	Paxton EM
Handsfree compatible	No
Door open time	1 sec - 60 secs
Silent operation	Yes

Electrical

Battery type	4 x AA 1.5V Alkaline
Battery life	Normal power mode: 20,000 operations Low power mode: 30,000 operations

Communication

TCP/IP	No
Wireless	2.4GHz (IEEE 802.15.4)
RS485	No
Recommended wireless devices per Net2Air Bridge	10
Optimum wireless range	15m/50ft
Encryption	AES 128bit

Features

Door widths supported	50mm/2"
Door contact	Yes
Rear handle exit request	Yes
Low battery warning	Yes
Flat battery jumpstart terminals	No

Lock case compatibility

Backset	70mm/2.75"
Rotation	70°
Lockset	Cylindrical lockset*
Single Action Egress	Yes

Environment

Operating temperature	0°C - +55°C +32°F - +131°F
Moisture resistance	No
Vandal Resistance	Low
Fire resistance	ANSI/UL 10C compliant (20 min fire doors), CAN/ULC S104 compliant (20 min fire doors)
UL	UL294, CSA 22-2 No. 20512



Net2 PaxLock is a secure wireless battery operated access control unit. Net2 PaxLock works with Paxton's Net2 software, allowing the end user networked access control for easy management. Net2 PaxLock provides live user tracking and alarm events like door forced and door held. It includes a key override for peace of mind.

Net2 PaxLock was designed to operate even if the connection to the server is lost. Allowing up to 10,000 users access rights for entry when offline.

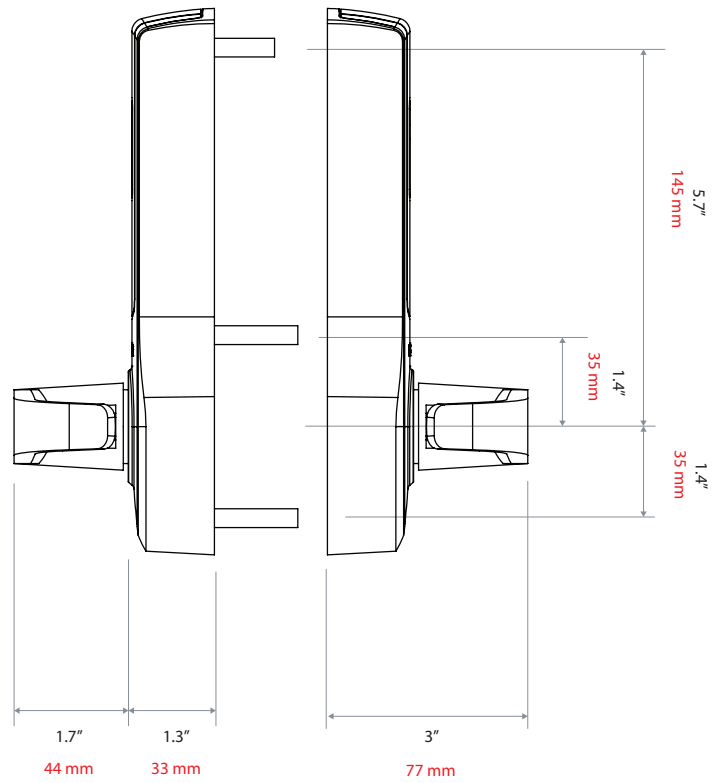
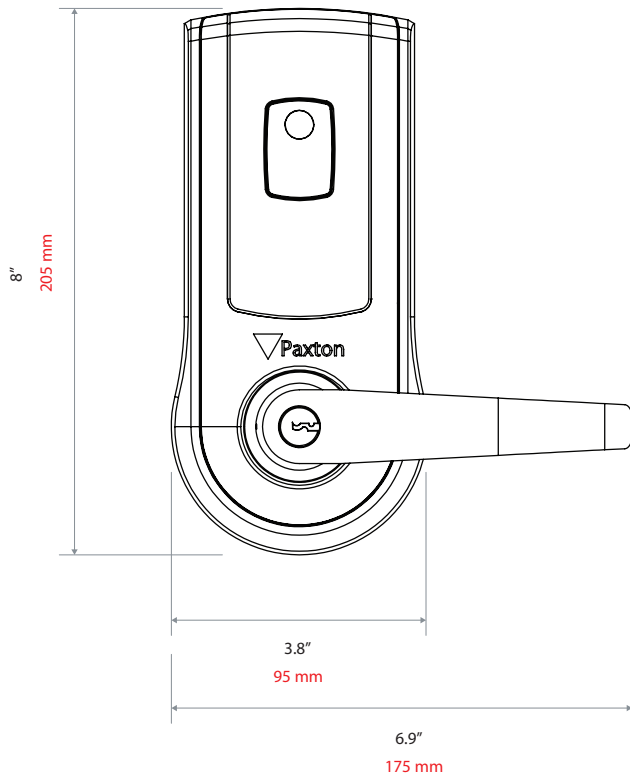

Accessories and sales codes

Net2 PaxLock US C Keyway - Galaxy	921-130-US
Net2 PaxLock US SFIC - Galaxy	921-160-US
Net2 PaxLock US Demo case	921-999-US

Net2 PaxLock US C Keyway - Eclipse	921-131-US
Net2 PaxLock US SFIC - Eclipse	921-161-US

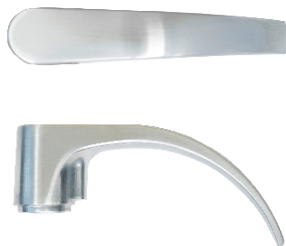

Net2 PaxLock Galaxy
style handle

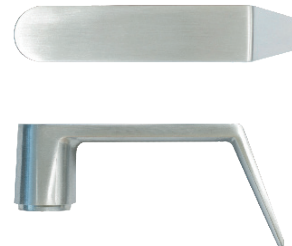

Net2 PaxLock Eclipse
style handle

*lock cylinder sold separately