



ASSA ABLOY

adamsrite.com



Follow us on Twitter at @AdamsRite



Subscribe to our YouTube Channel at AdamsRiteMfg



Like us on Facebook at Adams Rite



Connect with us on LinkedIn at Adams Rite

ASSA ABLOY is the global leader in door opening solutions, dedicated to satisfying end-user needs for security, safety and convenience

© 2017, Hanchett Entry Systems, Inc., an ASSA ABLOY Group company.

ARM-031-1216



ASSA ABLOY

Adams Rite Product Directory

adamsrite.com



Adams Rite has been manufacturing high quality locks for nearly 100 years. Our deadlocks, deadlatches and related hardware provide reliable security solutions for narrow stile aluminum, hollow metal and wood door applications.

Deadlocks Deadlatches Flushbolts & Pivots



ASSA ABLOY

ASSA ABLOY, the global leader
in door opening solutions



**RITE Touch®
RT1050
Digital Glass
Door Lock**

surface mounted keyless access control for single or double all-glass doors.



**MS1837 Series
MS® Two-Point
Deadlock**

maximum security for wood door pairs. A single turn drops a bolt into the threshold and pivots the MS bolt.

Concealed vertical rod not shown



**MS1850S
Series MS®
Deadlock**

the Original Maximum Security Deadlock. Utilizes a laminated stainless steel bolt, activated by a pivot mechanism to provide maximum security for a narrow stile door.



**MS1850S-X5X
Series MS®
Deadlock**

similar to MS1850S Deadlock with laminated stainless steel hookbolt.



The MS1850SN with laminated stainless steel bolt and MS1850SN-X5X with laminated stainless steel hookbolt are available for hollow metal or wood doors requiring ANSI prep.



**MS1950 Series
MS® Deadlock**

stainless steel version of the MS1850S (case and internal components).



**MS1950-X5X
Series MS®
Deadlock**

similar to MS1950 Deadlock with hookbolt (stainless steel case and internal components).



Adams Rite MS® deadlocks provide maximum security for narrow stile aluminum, hollow metal, and wood door applications.



MS1847 Series MS® Deadlock/Deadlatch

designed for ultra-narrow stile sliding doors, featuring a self-protecting, stainless steel bolt.

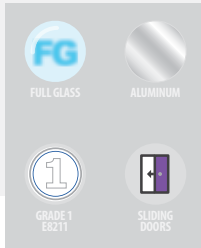

5017 Wood Door Deadlock/Deadlatch

Similar to the MS1847 Deadlock/Deadlatch, the 5017 provides the strength and deeper backset required to secure wood framed sliding doors. Bolt throw is adjustable by a screw in the faceplate.

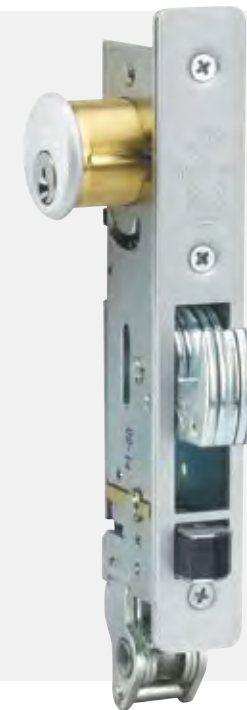
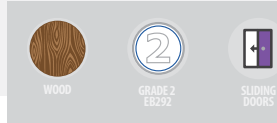

MS+1890 Series MS® Deadlock/Deadlatch

provides a maximum security deadlock for afterhours plus traffic control convenience during business hours.

Handles/paddles on both sides solve, with minimum traffic impediment, the problem of doors that stand ajar due to wind or air-conditioning pressures.

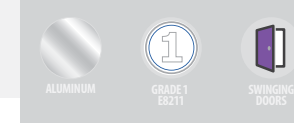

1875 Two-Point Deadlock

provides security for roll-up doors, security screens, or similar. Two bolts operate from either or both sides of the deadlock.



MS1861 Series MS® Bottom Rail Deadbolt

uses the same over-center/pivot locking mechanism as the basic MS® deadbolt, but lies horizontally in the bottom rail of ultra-narrow stile doors. Available with vertical bolt only or vertical and horizontal bolt options.

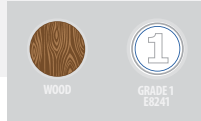

1830 Series Bottom Rail Deadlock (Swing Bolt)

provides bottom rail locking in ultra-narrow stile or tempered glass doors whose bottom rail is too shallow for the MS1861 Bottom Rail Deadbolt.



2331 Heavy Duty Deadbolt

for heavy duty wood or hollow metal sliding doors. Single turn of key or thumbturn throws a massive bolt into its strike then expands two stainless steel dogs to secure the door. There is no self-latching action.

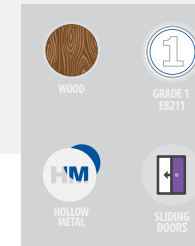

4070 Series Short Throw Deadbolt (Projection Style)

provides security for installations where the long-throw MS® Deadlock cannot be accommodated.





Dual Force® 2190
Interconnected Deadbolt/Deadlatch

Dual Force® 2290
Interconnected Deadbolt/Deadlatch

the 2190 for narrow stile aluminum doors, and 2290 for hollow metal or wood doors, combines the access control capabilities of a latch with the security of a deadbolt. With the deadbolt projected, a simple turn of the inside lever retracts both the latch and deadbolt simultaneously, providing code-compliant, single-motion, panic-proof exiting. Both are available with electrified trim sets for easy integration into an existing access control system.



| | | | | | |
|------|--------------|--------------------|--------------------|----------------|----------------|
| 2190 | ALUMINUM | ELECTRIFIED OPTION | GRADE 1 ER2102 | SWINGING DOORS | |
| 2290 | HOLLOW METAL | WOOD STILE OR RAIL | ELECTRIFIED OPTION | GRADE 1 ER2102 | SWINGING DOORS |



4189, 4190
Flush Locksets
(including deadlock)
all metal

for sliding doors, combines MS1847 with a slide button.

| | |
|--------------|---------------|
| ALUMINUM | GRADE 2 ER292 |
| HOLLOW METAL | SLIDING DOORS |

4189 4190



4430, 4431
Flush Locksets
(including deadlock)
ABS plastic

similar in function and size to 4189/4190, these feature escutcheons molded of sturdy ABS resin.

| | |
|--------------|---------------|
| ALUMINUM | GRADE 2 ER292 |
| HOLLOW METAL | SLIDING DOORS |

4431 4430

Options & Accessories for Deadlocks

Adams Rite Deadlocks including the MS® Maximum Security Deadlocks can be ordered with a variety of related products including strike plates, cylinder accessories and trim. Different deadlocks have different installation and cylinder requirements.



Steel Hawk® 4300 Electrified Deadlatch (eLatch)

with its patented two-way winged technology, the 4300 is the perfect electrified no-cut replacement for MS® deadbolts and deadlatches for aluminum and glass doors. The 4300 eLatch combines non-handed, narrow backset mechanical locking hardware with electrified access control. The ANSI/BHMA Grade 1 narrow backset deadlatch adapts to any door swing right out of the box. Compatible with existing handles, paddles and levers.

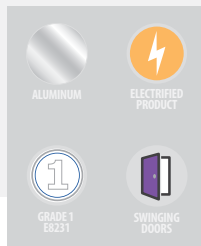

4510 and 4530 Standard Duty Deadlatches

provide flexible traffic control during and after business hours. The 4530 is designed to retrofit into the prep of older MS1850S Deadlocks and 4200 Deadlatches of the same backset.

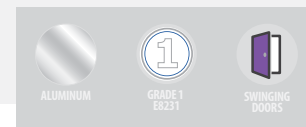

4781 Two-Point Deadlatch with Paddle

designed for paired, out-swinging narrow stile aluminum doors. Concealed vertical rods latch to header and threshold allowing both door leaves to remain active.

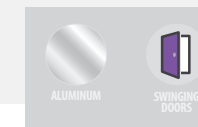

4900 Heavy Duty Deadlatch

provides flexible traffic control and easy installation for aluminum narrow stile doors. Interchangeable, without stile modification, with any MS1850S deadlock of the same backset.

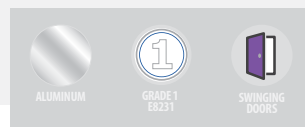

4920AN Heavy Duty Deadlatch (ANSI Size)

available for wood and hollow metal door applications prepared according to ANSI specifications.

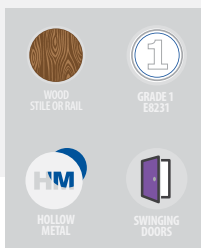

Options & Accessories for Deadlatches

Adams Rite Deadlatches can be ordered with a variety of related products including strike plates, cylinder accessories, electric strikes and trim. Different deadlatches have different installation requirements.



1870 Cylinder-Operated Flushbolt

designed for greater key control of aluminum narrow stile doors, prevents accidental locking of the inactive leaf of paired doors.



MS1880, MS1881 Two-Point Flushbolts

operates in conjunction with any MS® pivoting deadlock to provide greater convenience than flip-lever flushbolts, using one operation rather than two. Not to be used as a standalone locking mechanism.



The 1870HM Cylinder-Operated Flushbolt is available for hollow metal doors and the 1877 Cylinder-Operated Flushbolt can be used for wood doors. Both may be installed to lock at threshold or at header.



MS2180 Auto-Release Two-Point Flushbolt

operates in conjunction with any MS® pivoting deadlock to provide maximum security for paired doors. Not to be used as a standalone locking mechanism.



B1921, B1923 Reinforcing Pivots

reinforcing pivots take the load off the top hinge and transfer it to screws that are in shear so they will not pull off. The economical way to transfer load from hinges of sagging doors.

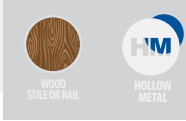

Options & Accessories for Flushbolts

Adams Rite Flushbolts & Pivots can be ordered with a variety of related products including strike plates, trim and cylinder accessories and compatible products such as Adams Rite deadlocks.

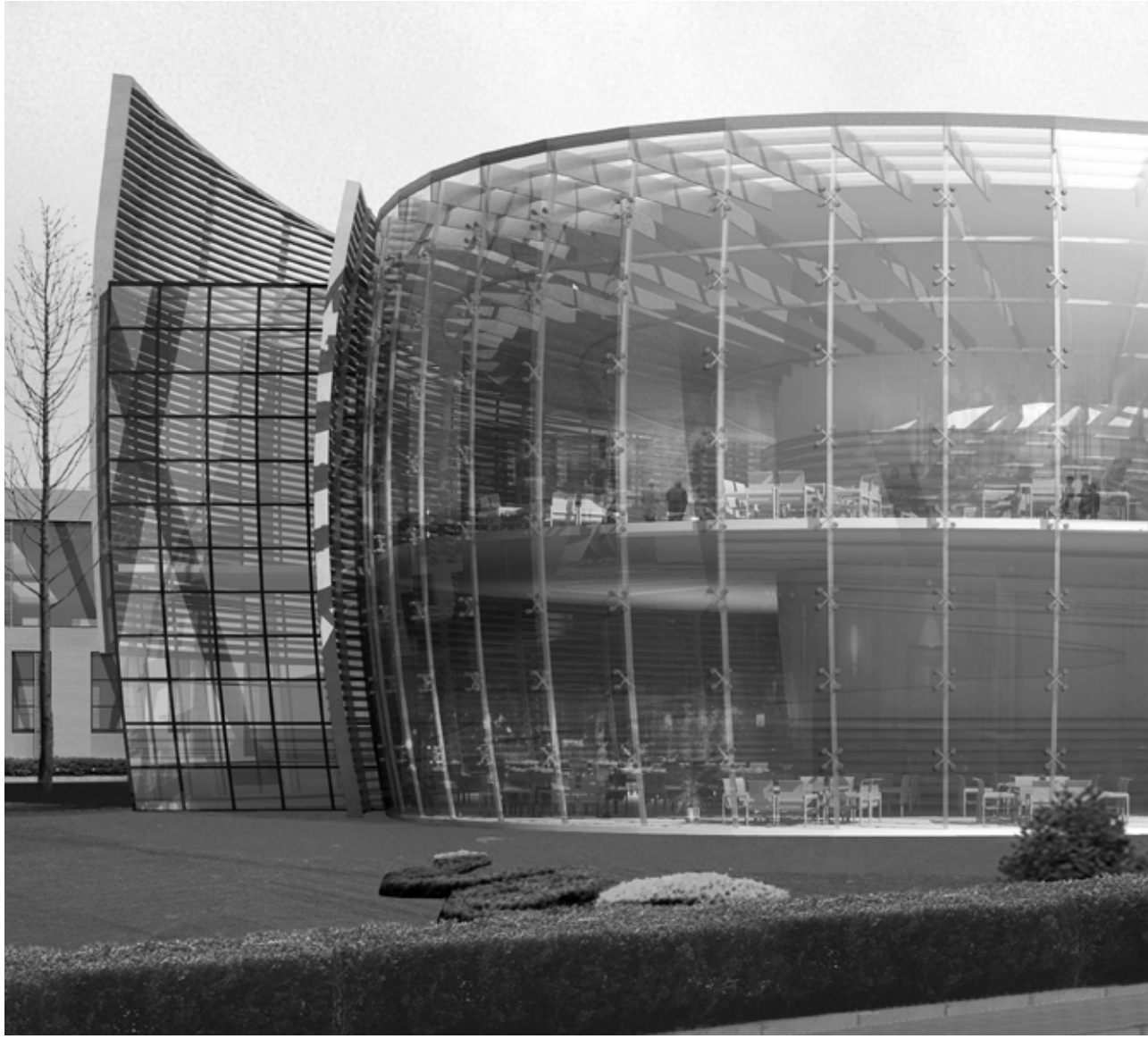

Every Adams Rite exit device we make combines our patented hardware with the slim, clean lines of our extruded aluminum pushbar. This gives designers and specifiers flexibility in application, while maintaining consistency in appearance. An extensive range of options and finishes assures that you get exactly the exit device you want.

Exit Devices



ASSA ABLOY

ASSA ABLOY, the global leader
in door opening solutions

Exit Device General Features

- Strong, durable constructions for a high level of security
- Clean, unobtrusive design
- Pushbar made of extruded aluminum, clad or anodized, in a variety of finishes

Fire-Rated Exit Devices for Wood and Hollow Metal Doors

APPLICATION AND RATING

| MODEL | TYPE | RATING | DOOR CONSTRUCTION | MAXIMUM SIZE SINGLE DOOR | MAXIMUM SIZE PAIRS AND DOUBLE EGRESS |
|-------|----------------------------|----------|----------------------|--------------------------|--------------------------------------|
| 3100 | SVR | 3 hr | Hollow Metal | 4'-0" x 10'-0" | 8'-0" x 10'-0" |
| 3100 | SVR | 90 min | Wood | 4'-0" x 10'-0" | 8'-0" x 9'-0" |
| 3100T | SVR-TRO | 3 hr | Hollow Metal | 4'-0" x 8'-0" | 8'-0" x 10'-0" |
| 3100W | SVR-TRO | 1-1/2 hr | Wood | 4'-0" x 8'-0" | 8'-0" x 8'-0" |
| 3100W | SVR-TRO | 20 min | Wood | 4'-0" x 9'-0" | 8'-0" x 9'-0" (std. pairs) |
| 3300 | SPM (Single Point Mortise) | 3 hr | Hollow Metal | 4'-0" x 10'-0" | 8'-0" x 10'-0" (active leaf) |
| 3600 | CVR | 3 hr | Hollow Metal | N/A | 8'-0" x 10'-0" |
| 3600T | CVR-TRO | 3 hr | Hollow Metal | N/A | 8'-0" x 10'-0" (std. pairs) |
| 3600T | CVR-TRO | 3 hr | Hollow Metal | N/A | 8'-0" x 8'-0" (double egress) |
| 3600T | CVR-TRO | 1-1/2 hr | Hollow Metal | N/A | 8'-0" x 10'-0" (double egress) |
| 3700 | RE (Rim Exit) | 3 hr | Hollow Metal or Wood | 4'-0" x 10'-0" | 8'-0" x 10'-0" |
| 3900 | CVR-TRO | 1-1/2 hr | Wood | 4'-0" x 9'-0" | 8'-0" x 9'-0" |

Where SVR-TRO is surface vertical rod-top rod only and CVR-TRO is concealed vertical rod-top rod only.

Surface Vertical Rod Features

- Patented top latching mechanism interlocks door to frame
- Adjustable steel rods protected in contoured covers
- Also available in top rod only version

3100 Series (Fire-Rated)
8100 Series (Life-Safety)

Surface Vertical Rod Exit Device for wood and hollow metal.

8200 Series (Life-Safety)

Surface Vertical Rod Exit Device for narrow stile aluminum.

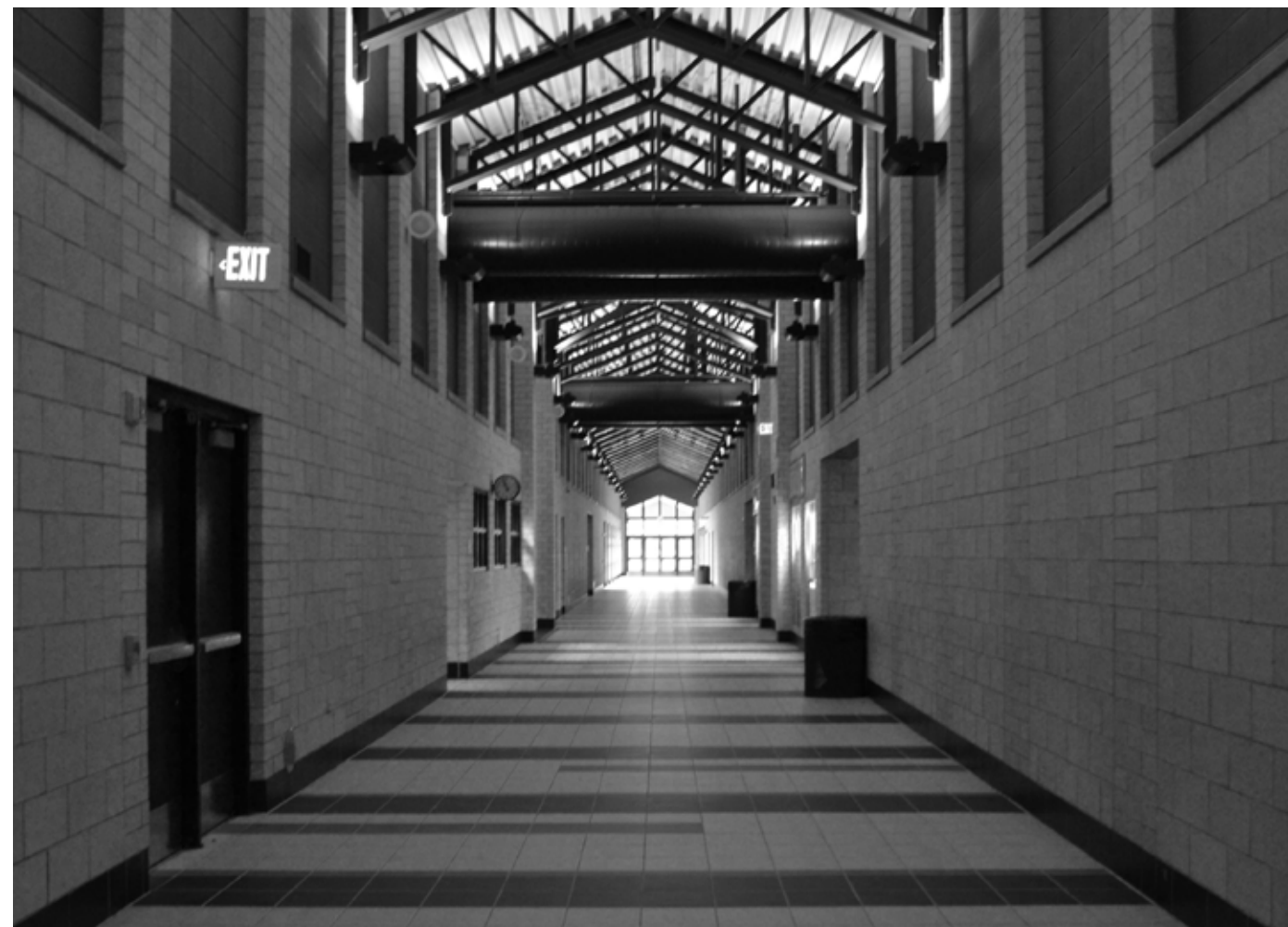

Mortise Features

- Heavy duty deadlatching mechanism
- Strike is made of stainless steel. Standard strike supplied



3300 Series (Fire-Rated)
8300 Series (Life-Safety)

Mortise Exit Device for wood and hollow metal for wood and hollow metal.

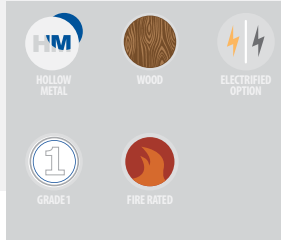

8400 Series (Life-Safety)

Mortise Exit Device for narrow stile aluminum.



3600 Series (Fire-Rated)
8500 Series (Life-Safety)

Concealed Vertical Rod Exit Device for hollow metal.

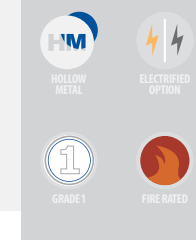

8600 Series (Life-Safety)

Concealed Vertical Rod Exit Device for narrow stile aluminum.

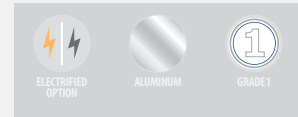

Concealed Vertical Rod Features

- Patented top latching mechanism interlocks door to frame
- Durable, adjustable steel rods



3900 Series (Fire-Rated)
8900 Series (Life-Safety)

Surface Concealed Vertical Rod Exit Device for wood.

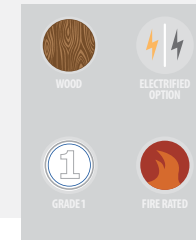

8650 Escutcheon
 required to mount any standard mortise cylinder, with MS® cam, on outside of door. Required only for Concealed Vertical Rod exit devices.





3700 Series (Fire-Rated)

8700 Series (Life-Safety)

Rim Exit device for wood and hollow metal.

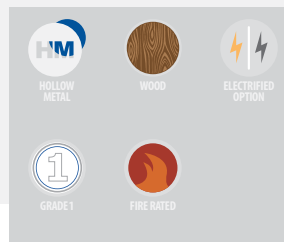

8800 Series (Life-Safety)

Rim Exit device for narrow stile aluminum doors.

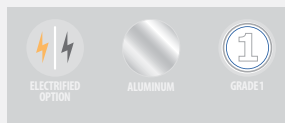

Rim Exit Features

- Patented "Starwheel" bolt interlocks door to frame

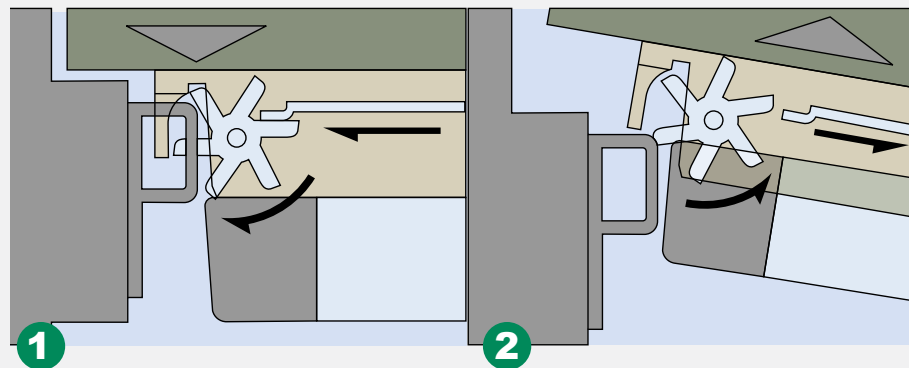

How the Starwheel Bolt Interlocks Door to Frame

The Adams RITE Starwheel has passed Windstorm testing as part of a system.

1. When door closes, the interlocking noseguard and Starwheel bolt close around the strike. The deadlocking slide spring over, locking the Starwheel bolt to the strike.
2. When pushbar is depressed, the deadlocking slide moves back, allowing the door to unlock from the strike. This unique interlock provides solid security and prevents jamb spreading.

Options & Accessories for Exit Devices

Adams Rite Exit Devices can be ordered with electrification options for standalone access control or integration with maglocks, card readers, keypads, fire alarms, power door operators, and other control systems. Different exit device types have different installation and power requirements.

- **Silent Electrification (SE) Motorized Latch Retraction:** provides near-silent operation for quiet environments such as hospitals, offices, hotels and libraries where solenoid-driven devices would be disruptive.
- **Electric Latch Retraction:** the EL option for rim exit devices and LR option for all other non-rim devices use a solenoid mounted in pushbar for instantaneous unlocking and locking of the exit device from a remote location or access control device.
- **Alarmed Exit Device:** this battery-operated option emits a loud alarm to notify management of unauthorized exit. Minimum opening width of 36". Cannot be ordered with other exit device options.

- **Monitoring/Signal Switch:** mounted in the exit device pushbar on the hinge end, the switch can be used to activate signal light, horn, monitor, or other devices.
- **Cylinder Dogging:** for management control of dogging exit devices; for life-safety exit devices only.
- **Electric Dogging:** a holding magnet keeps the pushbar depressed (set manually) and the latch retracted for lower profile exit devices, resulting in less damage and quieter operation.
- **Matching End Caps:** for all applications where it is preferable that the end caps match the finish of the exit device. Available for US finishes only.
- **Monitored Dummy Pushbar:** dummy pushbar with no latch mechanism but with either a single or dual monitor/signal switch. May be used with a maglock, where bar turns off magnet and allows exit from building.

The Adams Rite line of premium electric strikes, the UltraLine 7400 Series features an ultra-compact design and an adjustable stainless steel split-jaw with 1500 lbs of holding force in fail-secure mode, and will release electrically with up to 30 lbs of preload.

The 7100 Series electric strikes provide a variety of Grade 1 solutions for various applications. The 7200 Series is designed for openings requiring a 3-hour fire rating.



ASSA ABLOY

ASSA ABLOY, the global leader
in door opening solutions

Electric Strikes

7100 Series Electric Strikes

Overview

Adams Rite 7100 Series Electric Strikes are Grade 1 electric strikes, with multiple models providing a variety of flexible solutions. Designed for Adams Rite deadlatches, cylindrical and mortise locksets. Models are available for use with aluminum, hollow metal or wood doors and jambs.

Features

- ANSI/BHMA Grade 1 standards
- Compact size
- Available in 12, 16, or 24 VAC/VDC
- Field selectable fail-secure or fail-safe
- Compatible with Adams Rite deadlatches, cylindrical locks, or mortise locks
- Retrofits with previous Adams Rite electric strikes
- Low current draw
- Available with two optional monitoring signal switches

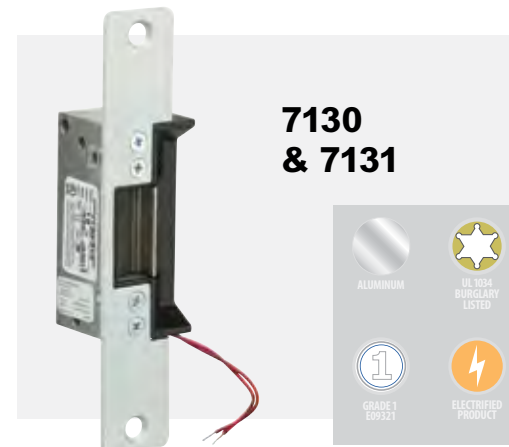

7200 Series Electric Strikes

Overview

Adams Rite 7200 Series Fire-Rated Electric Strikes are for use in hollow metal doors, in applications requiring a 3 hour fire rating. The 7240 is for cylindrical locksets with up to 5/8" latchbolt projection. The 7270 is for mortise or cylindrical locksets with up to 3/4" latchbolt projection without a deadbolt. The 7200 Series are assembled for fail secure (locked when unpowered) operation.

Features

- ANSI/BHMA Grade 1 standards
- Compact size
- Available in 12 or 24 VAC/VDC
- Fire-rated in fail-secure mode
- Low current draw
- Available with two optional monitoring signal switches



Complete 7100 and 7200 Series electric strike model information found on [Electric Strike Comparison Chart](#).

7400 Series Electric Strikes

Overview

Adams Rite 7400 Series Electric Strikes are designed for Adams Rite deadlatches or cylindrical locksets. 74R1 and 74R2 are for rim exit devices. An array of models are available for use with aluminum, hollow metal or wood doors and jambs.

With a robust and compact design featuring adjustable stainless steel split-jaws, and over 1,500 lbs of holding force, these non-handed UltraLine electric strikes can release electrically with up to 30 lbs of door preload. The 7400 Series operate

at 12, 16, and 24 VDC with one solenoid. Using jaw inserts of various sizes, the UltraLine 7400 Series Electric Strikes are adjustable to compensate for door and frame related preload and security problems.

Features

- Exceeds ANSI/BHMA Grade 1 standards
- Over 1,500 lbs of holding force
- Opens electrically with up to 30 lbs of preload
- Compact size
- Single solenoid operates at 12, 16, and 24 VDC
- Field selectable fail-secure or fail-safe
- Compatible with Adams Rite deadlatches, cylindrical locks, and rim exit devices
- Retrofits with all previous Adams Rite electric strikes
- Low current draw

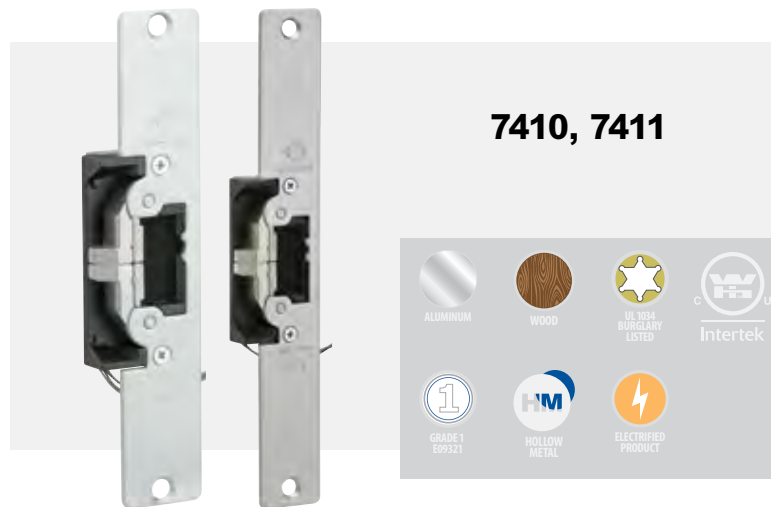

Complete 7400 Series electric strike model information found on Electric Strike Comparison Chart.

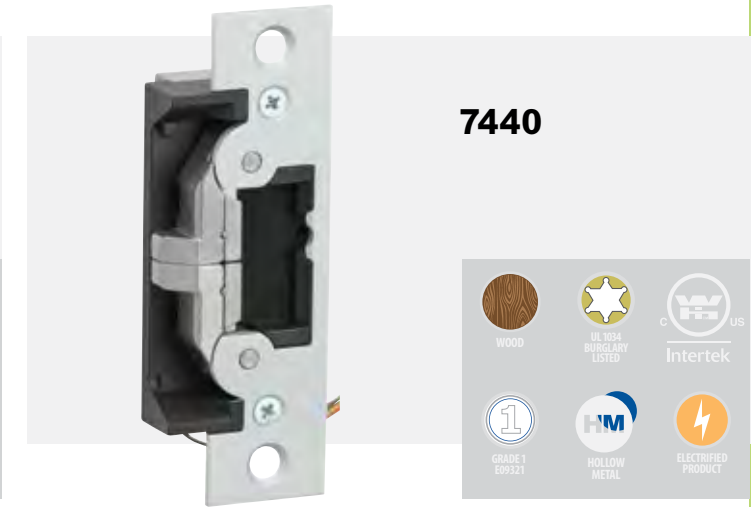
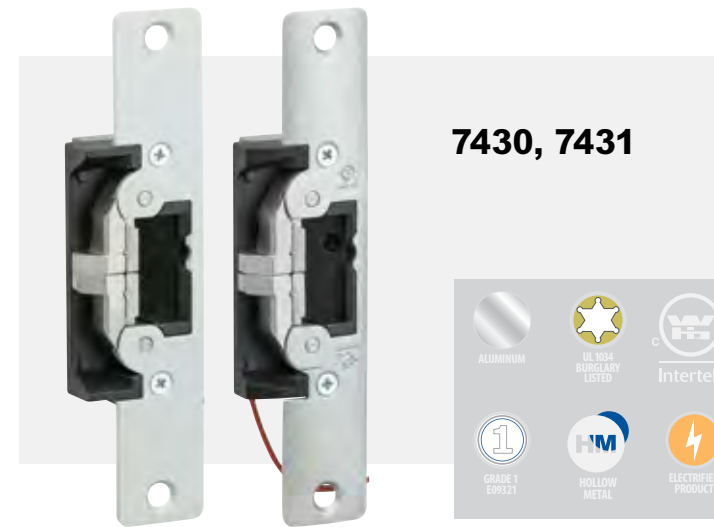

Options & Accessories for Electric Strikes

Adams Rite electric strikes have a variety of faceplates and finishes available as well as monitoring switches and lip extension kits to complement any application. Accessories such as power supplies, transformers and piezo horns are available separately.

Strike Comparison Chart

APPLICATION AND RATING

| | MODEL | APPLICATION | LOCKSET | CASE | FACEPLATE | STRIKE OPENING | ADAMS RITE DEADLATCHES | CYLINDRICAL LOCKS | MORTISE LOCKS | RIM EXIT DEVICES | VOLTAGE | CERTIFICATIONS |
|-----------------|-------|---------------------------------|---|----------------------------------|---|--------------------------------------|-----------------------------------|-----------------------------------|---------------------------|---------------------------|---|---|
| STANDARD | 7100 | Aluminum | Adams Rite Deadlatches, cylindrical locksets | 1" x 3-3/8" x 1-5/8" deep | Flat, 1-1/4" x 4-7/8" | 5/8" x 1-7/16 x 1/2" deep | 1/2" to 5/8" latchbolt projection | 1/2" to 5/8" latchbolt projection | - | - | Available in 12, 16, or 24 VAC or VDC | UL 1034 burglary-resistant listed; ANSI/BHMA A156.23, Grade 1 |
| | 7101 | Aluminum | Adams Rite Deadlatches, cylindrical locksets | 1" x 3-3/8" x 1-5/8" deep | Radius, 1-1/4" x 4-7/8" | 5/8" x 1-7/16 x 1/2" deep | 1/2" to 5/8" latchbolt projection | 1/2" to 5/8" latchbolt projection | - | - | Available in 12, 16, or 24 VAC or VDC | UL 1034 burglary-resistant listed; ANSI/BHMA A156.23, Grade 1 |
| | 7110 | Hollow metal, wood and aluminum | Adams Rite Deadlatches, cylindrical locksets | 1" x 3-3/8" x 1-5/8" deep | 1-7/16" x 7-15/16" | 5/8" x 1-7/16 x 1/2" deep | 1/2" to 5/8" latchbolt projection | 1/2" to 5/8" latchbolt projection | - | - | Available in 12, 16, or 24 VAC or VDC | UL 1034 burglary-resistant listed; ANSI/BHMA A156.23, Grade 1 |
| | 7111 | Hollow metal, wood and aluminum | Adams Rite Deadlatches, cylindrical locksets | 1" x 3-3/8" x 1-5/8" deep | 1-7/16" x 10-1/4" | 5/8" x 1-7/16 x 1/2" deep | 1/2" to 5/8" latchbolt projection | 1/2" to 5/8" latchbolt projection | - | - | Available in 12, 16, or 24 VAC or VDC | UL 1034 burglary-resistant listed; ANSI/BHMA A156.23, Grade 1 |
| | 7130 | Aluminum | Adams Rite Deadlatches, cylindrical locksets | 1" x 3-3/8" x 1-5/8" deep | Flat, 1-1/4" x 6-7/8" | 5/8" x 1-7/16 x 1/2" deep | 1/2" to 5/8" latchbolt projection | 1/2" to 5/8" latchbolt projection | - | - | Available in 12, 16, or 24 VAC or VDC | UL 1034 burglary-resistant listed; ANSI/BHMA A156.23, Grade 1 |
| | 7131 | Aluminum | Adams Rite Deadlatches, cylindrical locksets | 1" x 3-3/8" x 1-5/8" deep | Radius, 1-1/4" x 6-7/8" | 5/8" x 1-7/16 x 1/2" deep | 1/2" to 5/8" latchbolt projection | 1/2" to 5/8" latchbolt projection | - | - | Available in 12, 16, or 24 VAC or VDC | UL 1034 burglary-resistant listed; ANSI/BHMA A156.23, Grade 1 |
| | 7140 | Hollow metal and wood | Adams Rite Deadlatches, cylindrical locksets | 1" x 3-3/8" x 1-5/8" deep | Flat, 1-1/4" x 4-7/8" | 5/8" x 1-7/16 x 1/2" deep | 1/2" to 5/8" latchbolt projection | 1/2" to 5/8" latchbolt projection | - | - | Available in 12, 16, or 24 VAC or VDC | UL 1034 burglary-resistant listed; ANSI/BHMA A156.23, Grade 1 |
| | 7160 | Aluminum | Mortise or cylindrical | 1" x 3-3/8" x 1-7/8" deep | Flat, 1-1/4" x 4-7/8" | 3/4" x 1-7/16" x 5/8" deep | - | 3/4" latchbolt projection | 3/4" latchbolt projection | - | Available in 12, 16, or 24 VAC or VDC | UL 1034 burglary-resistant listed; ANSI/BHMA A156.23, Grade 1 |
| | 7170 | Hollow metal and wood | Mortise or cylindrical | 1" x 3-3/8" x 1-7/8" deep | Flat, 1-1/4" x 4-7/8" | 5/8" x 1-7/16" x 5/8" deep | - | 3/4" latchbolt projection | 3/4" latchbolt projection | - | Available in 12, 16, or 24 VAC or VDC | UL 1034 burglary-resistant listed; ANSI/BHMA A156.23, Grade 1 |
| FIRE RATED | 7240 | Hollow metal | Cylindrical | 1" x 3-3/8" x 1-5/8" deep | 1-1/4" x 4-7/8" | 5/8" x 1-7/16" x 9/16" deep | - | 5/8" latchbolt projection | - | - | Available in 12 or 24 VAC or VDC | UL 10C fire rated; CAN4-S104 (ULC-S104) fire door conformant; UL 1034 burglary-resistant listed; ANSI/BHMA A156.23, Grade 1 |
| | 7270 | Hollow metal | Mortise or cylindrical | 1" x 3-3/8" x 1-7/8" deep | 1-1/4" x 4-7/8" | 3/4" x 1-7/16" x 5/8" deep | - | 3/4" latchbolt projection | 3/4" latchbolt projection | - | Available in 12 or 24 VAC or VDC | UL 10C fire rated; CAN4-S104 (ULC-S104) fire door conformant; UL 1034 burglary-resistant listed; ANSI/BHMA A156.23, Grade 1 |
| PRELOAD CAPABLE | 7400 | Aluminum | Adams Rite Deadlatches, Cylindrical locksets | 1-13/32" x 3-3/8" x 1-1/16" deep | Flat, 1-1/4" x 4-7/8" | 5/8" adjustable x 1-7/16 x 1/2" deep | 1/2" to 5/8" latchbolt projection | 1/2" to 5/8" latchbolt projection | - | - | Field selectable to match power source of 12, 16, or 24 VDC.* | UL 1034 burglary-resistant listed; ANSI/BHMA A156.23, Grade 1 |
| | 7401 | Aluminum | Adams Rite Deadlatches, Cylindrical locksets | 1-13/32" x 3-3/8" x 1-1/16" deep | Radius, 1-1/4" x 4-7/8" | 5/8" adjustable x 1-7/16 x 1/2" deep | 1/2" to 5/8" latchbolt projection | 1/2" to 5/8" latchbolt projection | - | - | Field selectable to match power source of 12, 16, or 24 VDC.* | UL 1034 burglary-resistant listed; ANSI/BHMA A156.23, Grade 1 |
| | 7410 | Hollow metal, wood and aluminum | Adams Rite Deadlatches, Cylindrical locksets | 1-13/32" x 3-3/8" x 1-1/16" deep | 1-7/16" x 7-15/16" | 5/8" adjustable x 1-7/16 x 1/2" deep | 1/2" to 5/8" latchbolt projection | 1/2" to 5/8" latchbolt projection | - | - | Field selectable to match power source of 12, 16, or 24 VDC.* | UL 1034 burglary-resistant listed; ANSI/BHMA A156.23, Grade 1 |
| | 7411 | Hollow metal, wood and aluminum | Adams Rite Deadlatches, Cylindrical locksets | 1-13/32" x 3-3/8" x 1-1/16" deep | 1-7/16" x 10-1/4" | 5/8" adjustable x 1-7/16 x 1/2" deep | 1/2" to 5/8" latchbolt projection | 1/2" to 5/8" latchbolt projection | - | - | Field selectable to match power source of 12, 16, or 24 VDC.* | UL 1034 burglary-resistant listed; ANSI/BHMA A156.23, Grade 1 |
| | 7430 | Aluminum, hollow metal | Adams Rite Deadlatches, Cylindrical locksets | 1-13/32" x 3-3/8" x 1-1/16" deep | Flat, 1-1/4" x 6-7/8" | 5/8" adjustable x 1-7/16 x 1/2" deep | 1/2" to 5/8" latchbolt projection | 1/2" to 5/8" latchbolt projection | - | - | Field selectable to match power source of 12, 16, or 24 VDC.* | UL 1034 burglary-resistant listed; ANSI/BHMA A156.23, Grade 1 |
| | 7431 | Aluminum, hollow metal | Adams Rite Deadlatches, Cylindrical locksets | 1-13/32" x 3-3/8" x 1-1/16" deep | Radius, 1-1/4" x 6-7/8" | 5/8" adjustable x 1-7/16 x 1/2" deep | 1/2" to 5/8" latchbolt projection | 1/2" to 5/8" latchbolt projection | - | - | Field selectable to match power source of 12, 16, or 24 VDC.* | UL 1034 burglary-resistant listed; ANSI/BHMA A156.23, Grade 1 |
| | 7440 | Hollow metal and wood | Adams Rite Deadlatches, Cylindrical locksets | 1-13/32" x 3-3/8" x 1-1/16" deep | 1-1/4" x 4-7/8" | 5/8" adjustable x 1-7/16 x 1/2" deep | 1/2" to 5/8" latchbolt projection | 1/2" to 5/8" latchbolt projection | - | - | Field selectable to match power source of 12, 16, or 24 VDC.* | UL 1034 burglary-resistant listed; ANSI/BHMA A156.23, Grade 1 |
| | 74R1 | Hollow metal, wood and aluminum | Rim Exit Devices with Pullman type latchbolts | 1-13/32" x 3-3/8" x 1-1/16" deep | 1-3/4" x 9" x 11/16" (faceplate not separate) | 5/8" x 1-7/16" x 9/16" deep | - | - | - | 3/4" latchbolt projection | Field selectable to match power source of 12, 16, or 24 VDC.* | UL 1034 burglary-resistant listed; ANSI/BHMA A156.23, Grade 1 |
| | 74R2 | Aluminum | Rim Exit Devices with Pullman type latchbolts | 1-13/32" x 3-3/8" x 1-1/8" deep | 1-5/8" x 9" x 1/2" (faceplate not separate) | 5/8" x 1-7/16" x 1/2" deep | - | - | - | 1/2" latchbolt projection | Field selectable to match power source of 12, 16, or 24 VDC.* | UL 1034 burglary-resistant listed; ANSI/BHMA A156.23, Grade 1 |

* 16 VDC requires adapter. Adams Rite 4603 Rectifier required to convert low voltage AC current to DC current of same voltage. Please contact factory when using in AC mode.

Electric Strike Comparison Chart

ELECTRIC STRIKES

Adams Rite trim products are designed to add detail and functionality to door openings. Our levers and paddles are designed to easily integrate with our deadlocks and deadlatches and are available in a range of architectural finishes and styles to complement any door. The Adams Rite eForce suite of electrified trim offers convenient and keyless entry for basic to advanced access control.



ASSA ABLOY, the global leader
in door opening solutions

Trim

TRIM



eForce®3090-150, 3090P/C, A100 Keyless Entry

the battery-operated eForce®3090-150, A100-3090H with wireless Aperio® technology, and hardwired eForce 3090P/C are keyless entry controls for Adams Rite deadlocks, deadlatches and exit devices, that are compatible with narrow stile aluminum, hollow metal and wood door applications.

- The battery powered eForce®3090-150 provides basic access control for openings that don't require an audit trail. It can accommodate up to 150 users and features an outdoor-rated keypad that can be programmed in three modes.
- The 3090P (Prox) and 3090C (iCLASS) feature a hard-wired integrated HID® Prox or iCLASS contactless card reader that interfaces with any Wiegand-compatible access control system.
- The A100-3090H features Aperio technology and can wirelessly upgrade a mechanical door to a fully-functioning online door. Provides audit trail capabilities with either an HID® Prox or iCLASS contactless card reader that can integrate into an existing access control system.

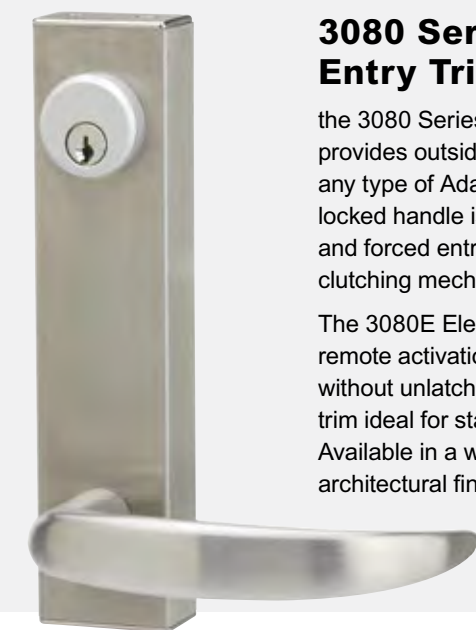

3080 Series Entry Trim

the 3080 Series Electrified Entry Trim provides outside activation for doors with any type of Adams Rite exit device. The locked handle is protected from vandalism and forced entry with a breakaway clutching mechanism.

The 3080E Electrified Entry Trim enables remote activation of the locking function without unlatching the door, making this trim ideal for stairwell and fire doors. Available in a wide range of architectural finishes.

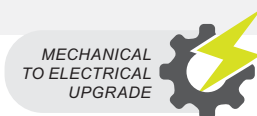
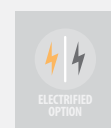

4600 Heavy Duty Designer Deadlatch Handles

designed to match the clean lines of a narrow stile door, the 4600 Deadlatch Handles combine aesthetics, function, and strength in a compact yet robust package.

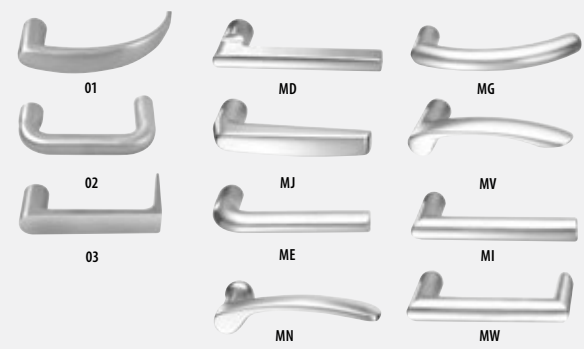

Lever handles are available in standard and designer series for 3080 Series Entry Trim and 4600 Heavy Duty Designer Deadlatch Handles.



4590 Deadlatch Paddle

ergonomically-friendly alternative to a knob or lever handle. Operates 4300, 4500 and 4900 Deadlatches, MS+1890 Deadlock and 2190/2290 Interconnected Deadlock/Deadlatch



4591 Deadlatch Paddle

same features and operation as 4590 paddle but with a more contemporary design and a hex key for dogging ("push" versions only). Optional monitor switch available.



4550 MS® Deadlock Lever

easily unlocks an MS® Deadlock (except for 7/8" backset locks) with approximately three pounds of downward force. ADA compliant.



4568, 4569 Eurostyle Deadlatch Handles

operate the 4300, 4500 and 4900 deadlatches. Can also be used without cam plug with MS+1890.





4560: ADA compliant, shaped to fit the hand

4560, 4565 Deadlatch Handles

operate the 4300, 4500 and 4900 deadlatches. Can also be used without cam plug with MS+1890.



4565: thumbturn for a firm, fingertip grip



1000 Series Turns
for operating MS1847 and 5017 Deadlocks/Deadlatches



Cylinders Accessories Power





4024, 4025, 4026 Cylinder Pulls

designed to operate MS1847 and 5017 deadlocks.



4036 Mortise Cylinder

provides five-pin security with most Adams Rite deadlocks or deadlatches.



4066 Thumbturn

operates deadlocks or deadlatches without a key.



MS4043 Cylinder Guard

hardened-steel ring to protect cylinder from vandalism.



4089 Exit Indicator

provides exit door notification for various Adams Rite deadlocks.



4000 Series MS® Deadlock Strikes

add aesthetics and finish to strike cutout in jambs.

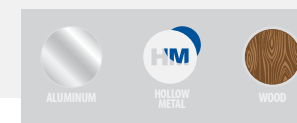

4800 Series Strikes

add aesthetics and finish to strike cutouts in jambs. The 4800 can be fit to nearly any sliding door using a mortised MS1847 Deadlock/Deadlatch. Use 4801 for hollow metal, 4802 for wood. MS4804 reinforcing strike provides strength equal to that of the stainless steel bolt of the MS1847.

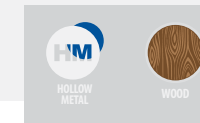

4901, 4902 Deadlatch Strikes

add aesthetics and finish to strike cutouts in jambs. Designed for use with 4300, 4500, 4900 and existing 4700 Series Deadlatches.

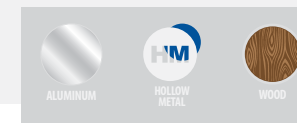

4016 Header Bolt A

the 4016 simultaneously extends a stainless steel hexbolt into the header and pivots the MS bolt into the mating door's stile, creating a two-point lock and securing the entire double door entrance, when used in conjunction with a basic MS® Deadlock.



4085 Header Bolt (Pairs of Doors Only) B

designed to add a top-of-door third locking point for pairs of doors with an MS® pivoted bolt deadlock and 4015 threshold bolt in the active leaf.



4015 Threshold Bolt C

simultaneously drops a stainless steel hexbolt into the threshold and pivots the massive MS® bolt into the mating door's stile, creating a two-point lock and securing the entire double door entrance, when used in conjunction with a basic MS1850S or MS1850SN deadlock.



For 4015, 4016, 4085: When used in conjunction with a header or threshold bolt, Adams Rite's MS® Deadbolts can achieve a two or three point locking system for any application.



PS-SE Power Supply

for all 3000 and 8000 Series exit devices with SE Option. Operates at 24VDC to power up to two SE exit devices in sequential or independent modes. A Battery Backup Kit is available separately. Sized to accommodate two 7AH sealed lead acid batteries (not included).



PS-1 Power Supply

one amp linear power supply with integrated battery backup circuitry for electric strikes, maglocks and other access control devices.



PS-LR Power Supply

linear power supply for vertical rod and mortise type exit devices with LR Option. Designed to power up to two 3000 LR or 8000 LR exit devices in sequential or independent modes. A Battery Backup Kit is available separately. Sized to accommodate two 7AH sealed lead acid batteries (not included).

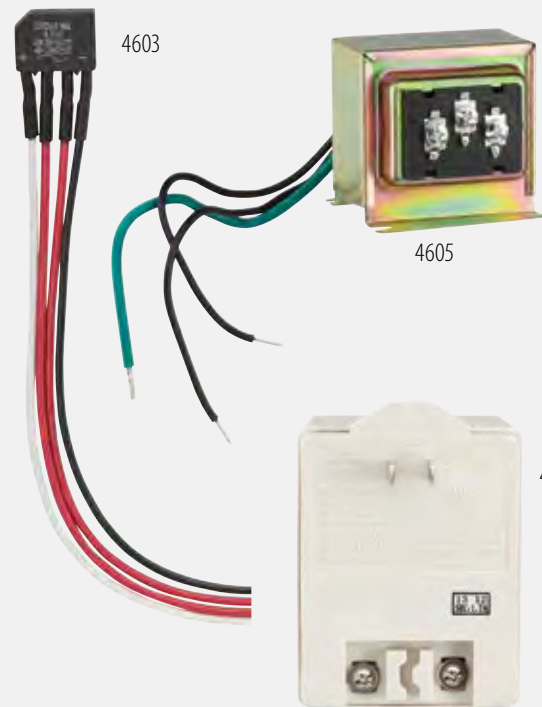

Transformer, Rectifier, Piezo Horn

4603 Rectifier 2 Amp rectifier converts low voltage AC current to DC of same voltage.

4605 Transformer converts 120 VAC current to 12 or 24 VAC.

4606 Transformer converts 120 VAC current to 24 VAC only.

29-0218 Piezo Horn provides for audible indication of when a DC strike is energized.



4612 Power Transfer Device

provides a secure and unobtrusive means of channeling electrical wiring from the door frame into the door itself, for powering electric strikes, locks, exit bars and more. Suitable for any door with butt-type or continuous hinges or pivots offset 3/4" or less

Information

For detailed product technical information, available training courses, marketing tools, complete warranty information, our commitment to sustainability, and information about where to purchase Adams Rite products please visit AdamsRite.com

Icon Glossary

| ICON | CLASSIFICATION | DESCRIPTION | ICON | CLASSIFICATION | DESCRIPTION |
|------|----------------------------------|---|------|---------------------|--|
| | FIRE-RATED | Products with a fire rating have been evaluated and listed to UL10B, "Fire Test of Door Assemblies" and UL10C, "Positive Pressure Fire Tests with Door Assemblies". The hourly rating qualification is also noted. | | ALUMINUM | This product suitable for aluminum doors. |
| | GRADE 1 | Passed Requirements of 1500 lbs. static force, 70 ft. lbs of impact force and withstands 500,000 cycles of operation. | | ELECTRIFIED OPTION | This product is available with electrification option. |
| | GRADE 2 | Passed requirements of 1000 lbs. static force, 50 ft. lbs. of impact force and withstands 300,000 cycles of operation. | | ELECTRIFIED PRODUCT | This is an electrified product. |
| | UL 1034 BURGLARY LISTED | Products with a UL 1034 listing are compliant as burglary resistant electric locking mechanisms. | | FULL GLASS DOOR | This product suitable for full glass doors. |
| | UL LISTING | UL Listing means that UL has tested representative samples of the product and determined that it meets UL's requirements. These requirements are based primarily on UL's published and nationally recognized Standards for Safety. | | HOLLOW METAL DOOR | This product suitable for hollow metal doors. |
| | UL LISTING | UL Listing means that UL has tested representative samples of the product and determined that it meets UL's requirements. These requirements are based primarily on UL's published and nationally recognized Standards for Safety. This icon indicates compliance with both Canadian and US requirements. | | ROLL-UP DOOR | This product suitable for roll-up doors. |
| | WARNOCK-HERSEY/INTERTEK LISTING | Intertek Listing means that Intertek has tested representative samples of the product and determined that it meets Intertek's requirements. These requirements are based primarily on Intertek's published and nationally recognized Standards. | | WOOD DOOR | This product suitable for wood doors. |
| | MECHANICAL TO ELECTRICAL UPGRADE | Adams Rite offers products to easily upgrade aluminum and glass openings from mechanical to electrified. | | SLIDING DOORS | This product suitable for sliding doors. |
| | | | | SWINGING DOORS | This product suitable for swinging doors. |