



MODEL: VCA608LED-HEWH/VCA608LED-HEBK/VCA728-HEWH/VCA728-HEBK



Description

The energy-saving ceiling fan with its powerful and quiet BLDC motor technology. The excellent power electronics control and air flow design make the ceiling fan run smoothly and quietly. Our easy-pairing and easy-to-read hand-held RF remote controller can send signals to the ceiling fan in far distance. The simple & chic exterior design is eye-catching.

DC Motor

- Power rating of 120 volts/60Hz
- Brushless DC motor engineered to run continuously
- Removable with permanently lubricated plug-in motor
Built-in soft start function to increase bearings' life

Blades/Housing

- Advanced aerodynamic profiled ABS blades and decorative motor housing
- Color/Finish: Black & White
- Easy installation
- Automatically powers OFF when blades are locked abnormally

Downrod

- Made with high-strength material
- Threaded downrod 3/4" Dia x 6" L, tighter

Remote Control

- Includes Fan/Light handheld remote control
- 6 speeds, reverse and dimmable function
- Easy pairing

Light

- 20-Watt LED light included (equivalent to a 100 watt incandescent bulb)
- Light output 1500 Lumens, >90CRI and 3000K CCT
- Dimmable Lighting
- Fan & Light separately control.

Warranty

- 3-year limited warranty

CERTIFICATIONS



TYPICAL SPECIFICATION

Breez RioVista VCA608LED and VCA728LED are 60 & 72 inches, 8 blades Ceiling Fan with Light and Remote Control. ENERGY STAR most efficient qualified with brushless DC motor engineered to run continuously for a minimum 70,000 hours ; airflow above 6000 CFM ; power consumption lower than 25 Watts. Wet-rated ceiling fans can apply in different spaces, such as living room, dining room, bedroom, and patio. Light commercial application will be restaurant, office, hotel, and resort.

DIMENSIONS

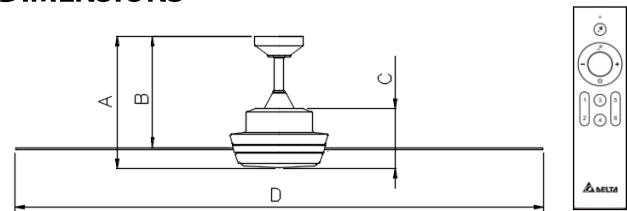

Model	VCA608LED	VCA728LED
A	15"	15"
B	12.6"	12.6"
C	16.7"	16.7"
D	60"	72"

Ceiling Fan	VCA608LED-HEWH	VCA608LED-HEBK	VCA728LED-HEWH	VCA728LED-HEBK
Color/Finish	White	Black	White	Black
Weighted-Average Air Flow (CFM)	4,473		5,093	
Weighted-Average Power Consumption (Watts)	12		12	
Air Flow at High Speed (CFM)	6,100		7,200	
Power Consumption at High Speed (Watts)	17		25	
Energy Efficiency (CFM/Watt)	383		409	
Current (Amps)	0.90 Max			
Power Rating (V/Hz)	120/60			
LED Light (Watts)	20			

Model	Quantity	Comments	Project:
			Location:
			Architect:
			Engineer:
			Contractor:
			Submitted by:
			Date: